

Sieger Design

DECK-MOUNTED SINGLE-LEVER TUB MIXER

29200885



FEATURES

- xStream ceramic disc cartridge
- 2 pcs. 1/2" x 4" copper supply lines (hot/cold)
- 1/2" x 6 5/8" copper supply line
- Optional flange included
- 3 1/8" diameter flange for mixer
- Lever(s) included
- 1 3/8" hole diameter deck valve

BODY FINISHES

- 00 polished chrome
- 06 platinum matt

CODES

ANSI/ASME A112.18.1

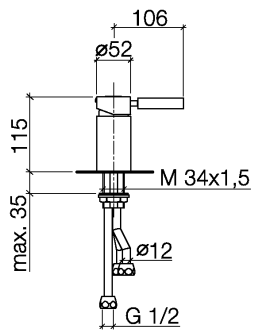

29.200.885-FF

Line Drawing Conversion: mm x 0.0394 = inches

Sieger Design

DECK-MOUNTED SINGLE-LEVER TUB MIXER

29200885

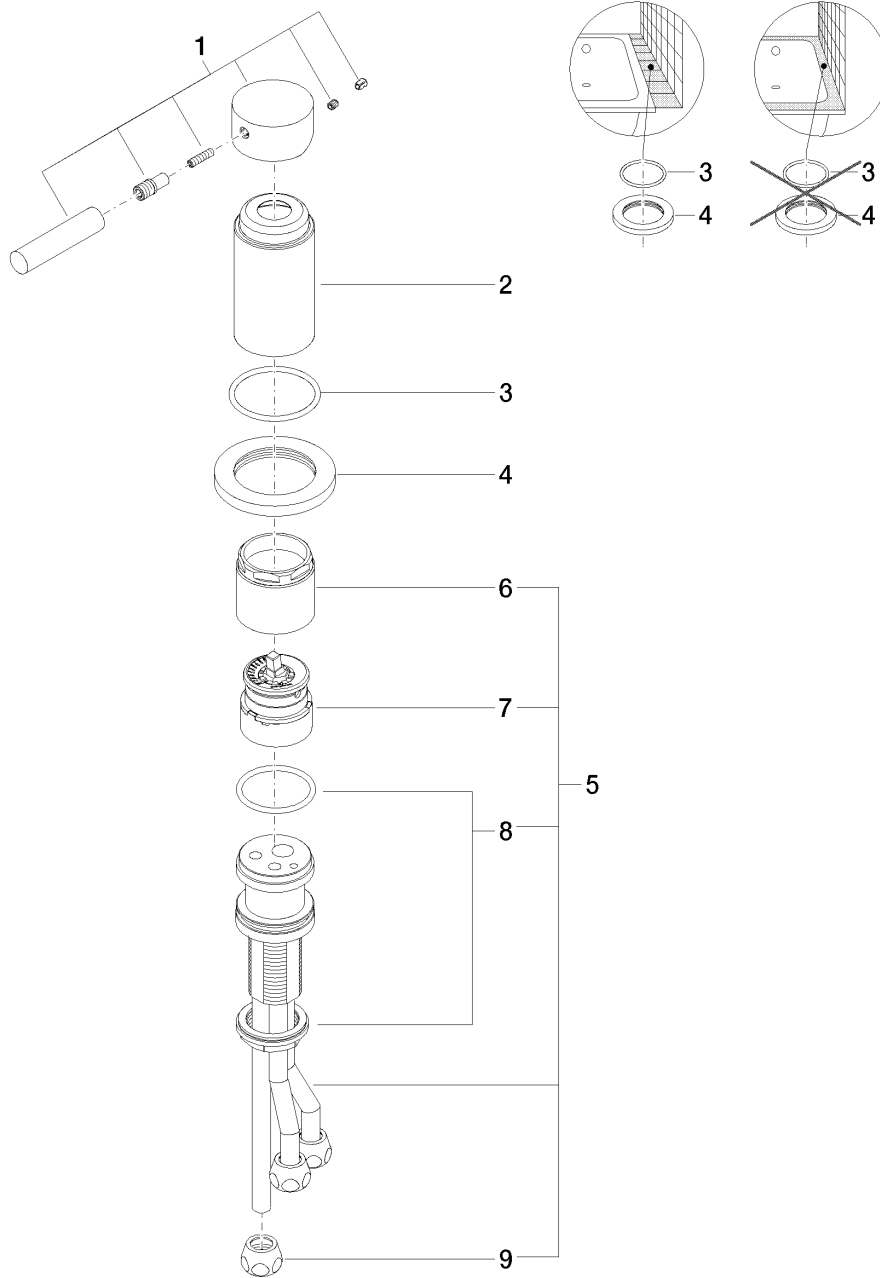

Sieger Design

DECK-MOUNTED SINGLE-LEVER TUB MIXER**29200885**

Posno	Partnumber	Designation	Sheeting Qty	Order Qty
1	90208804400ff	handle	1	1
2	091102113ff	cover	1	1
3	09141012990	seal	1	1
4	092762002ff	rosette	1	1
5	0415050509890	cartridge	1	1
6	09170103390	base	1	1
7	09150505090	cartridge	1	1
8	0423100410090	fixing set	1	1
9	0423300410090	threaded connector	3	1

Sieger Design

DECK-MOUNTED SINGLE-LEVER TUB MIXER

29200885



TARA .LOGIC BY DORNBRAUCHT

DECK-MOUNTED SINGLE-LEVER TUB MIXER

- xStream ceramic disc cartridge
- 2 pcs. 1/2" x 4" copper supply lines (hot/cold)
- 1/2" x 6 5/8" copper supply line
- Optional flange included
- 3 1/8" diameter flange for mixer
- Lever(s) included
- 1 3/8" hole diameter deck valve